

EDEN MIDCALF
— SALES & LETTINGS —

PCM

£900 PCM
Richardson Drive

Stourbridge, DY8 4DW

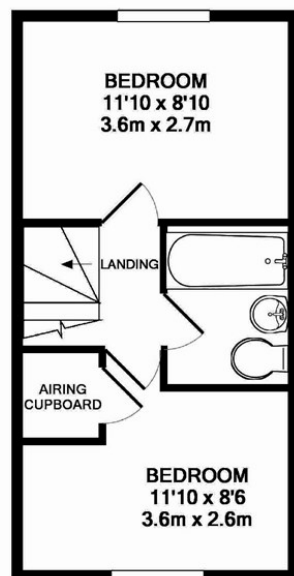
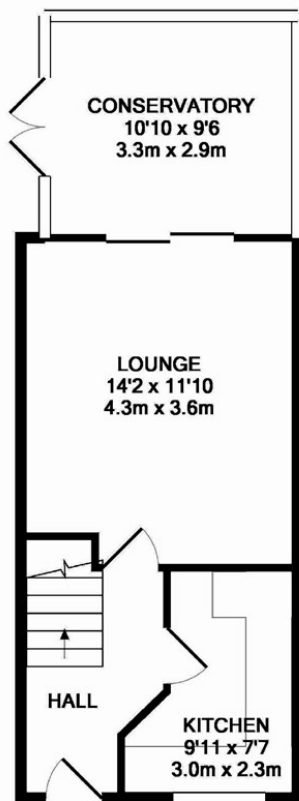

1ST FLOOR
APPROX. FLOOR
AREA 284 SQ.FT.
(26.4 SQ.M.)



GROUND FLOOR
APPROX. FLOOR
AREA 387 SQ.FT.
(36.0 SQ.M.)

TOTAL APPROX. FLOOR AREA 672 SQ.FT. (62.4 SQ.M.)

Whilst every attempt has been made to ensure the accuracy of the floor plan contained here, measurements of doors, windows, rooms and any other items are approximate and no responsibility is taken for any error, omission, or mis-statement. This plan is for illustrative purposes only and should be used as such by any prospective purchaser. The services, systems and appliances shown have not been tested and no guarantee as to their operability or efficiency can be given

Made with Metropix ©2018



Energy Efficiency Rating		
	Current	Potential
Very energy efficient - lower running costs		
(92 plus) A		90
(81-91) B		
(69-80) C		
(55-68) D	58	
(39-54) E		
(21-38) F		
(1-20) G		
Not energy efficient - higher running costs		
England & Wales		
EU Directive 2002/91/EC		



Agents Note: Whilst every care has been taken to prepare these particulars, they are for guidance purposes only. All measurements are approximate and are for general guidance purposes only and whilst every care has been taken to ensure their accuracy, they should not be relied upon and potential buyers/tenants are advised to recheck

EDEN MIDCALF
SALES & LETTINGS

42 Hagley Road
Stourbridge
West Midlands
DY8 1QD

01384 443434
lettings@edenmidcalf.co.uk
<https://www.edenmidcalf.co.uk/>